

Shadow Study & Comparison

The following diagrams illustrate a shadow comparison between the preferred concept of four story buildings on Main Street and a hypothetical scenario with two story buildings. The main purpose of this study is to visualize the impact of shadows cast by the concept on Main Street. Shadows are analyzed during winter (Jan. 15) and summer (July 15) seasons at three hour intervals between 9 am and 3 pm. The preferred concept buildings are rendered in tan, while existing buildings are white.



Jan. 15

Four - Stories

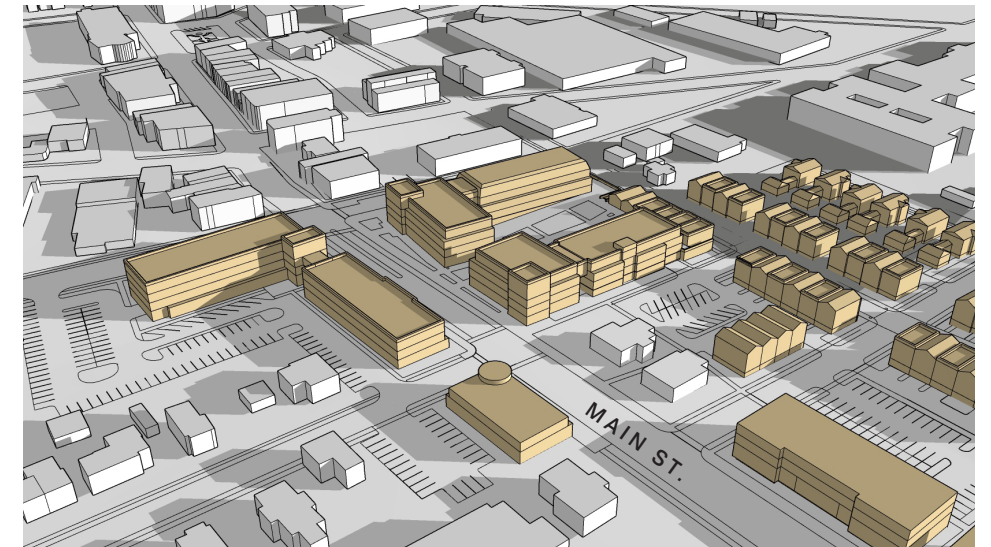
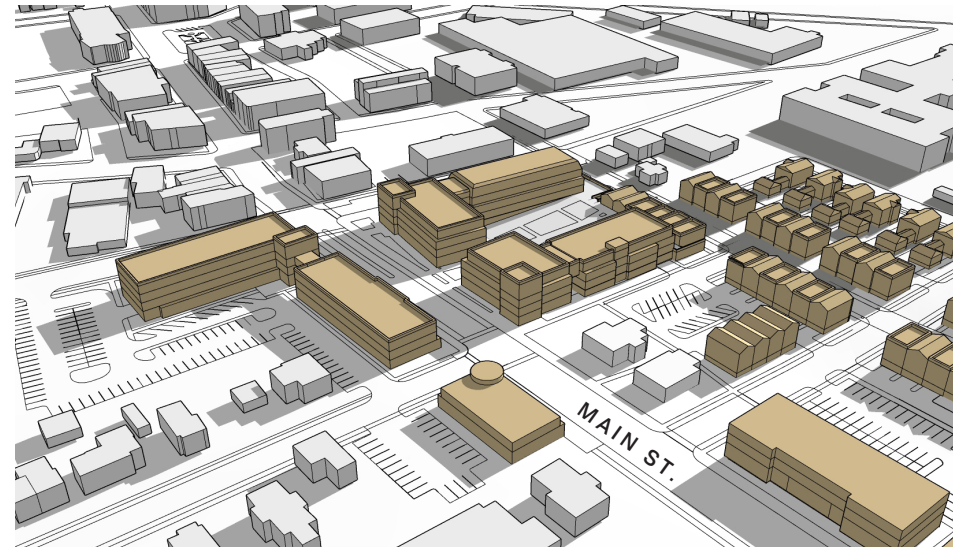

9 am

12 pm

3 pm

Two - Stories

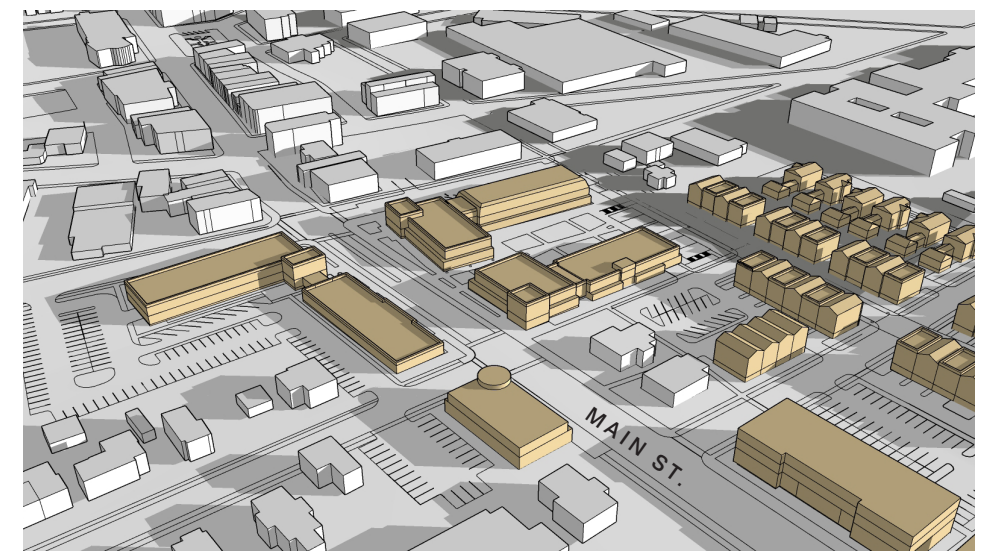
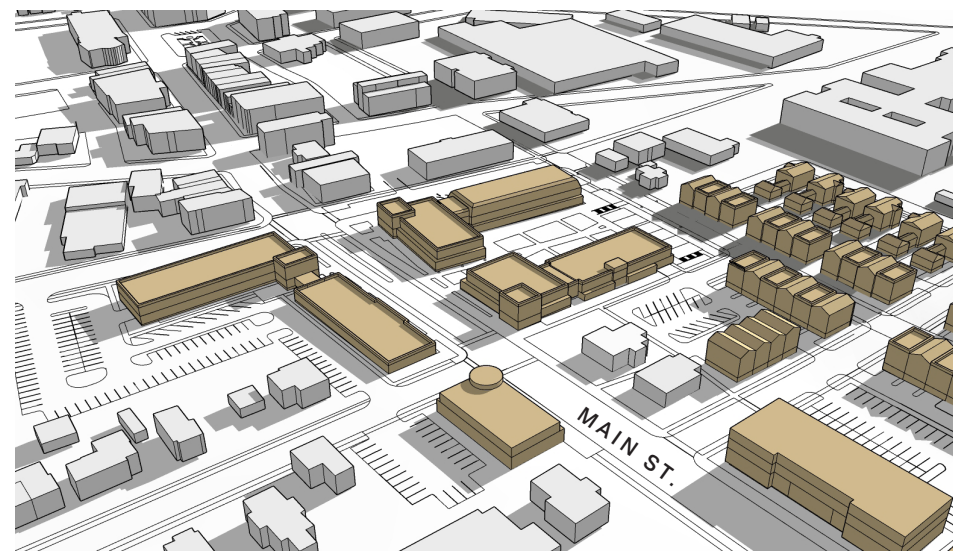
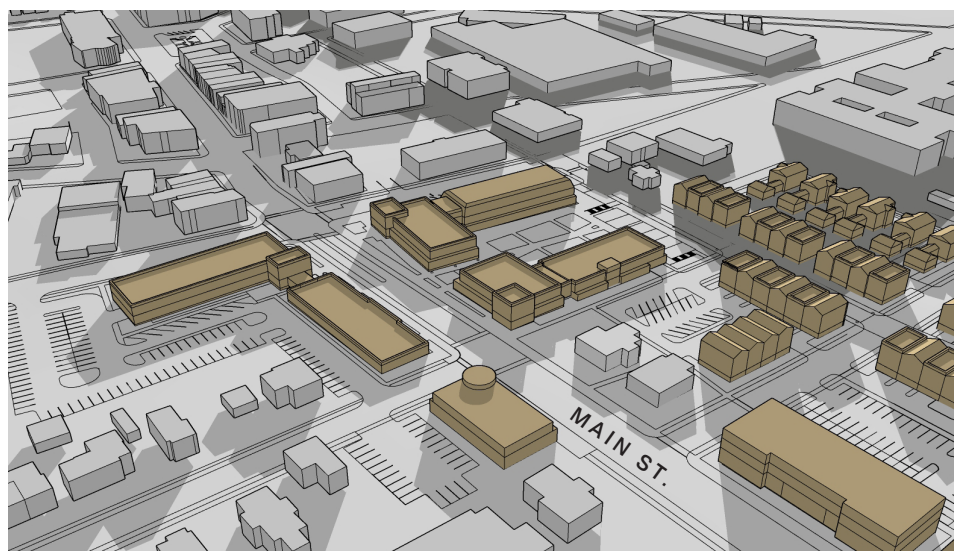

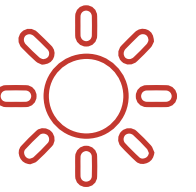

July 15

Four - Stories

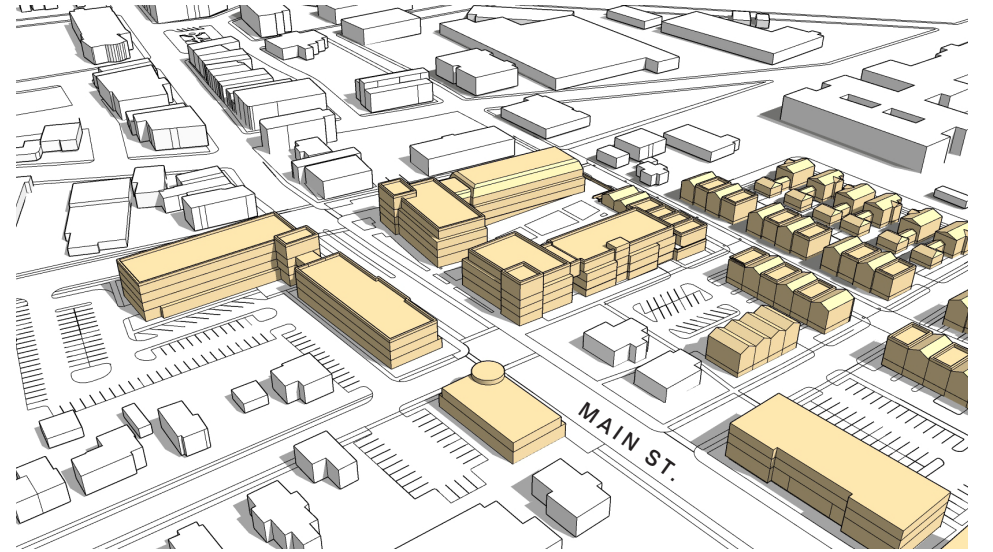
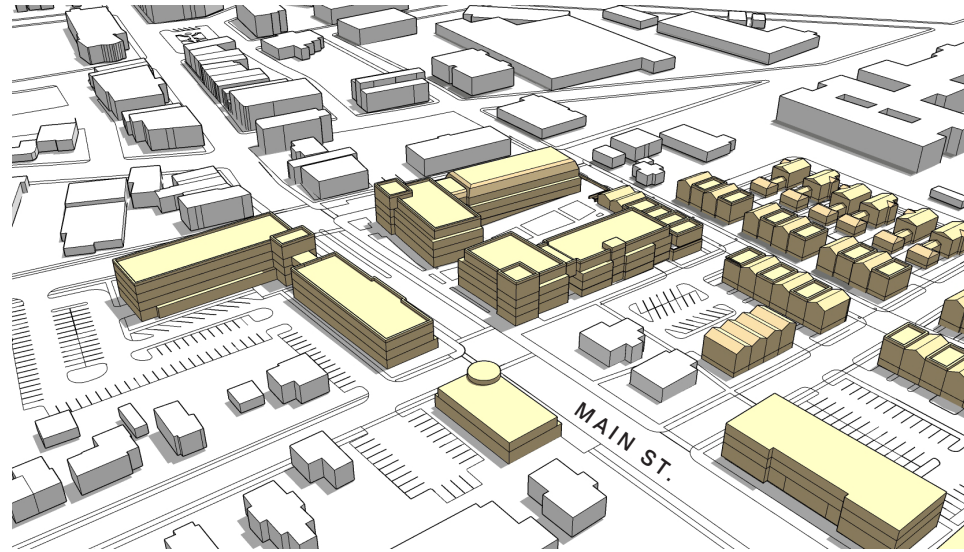
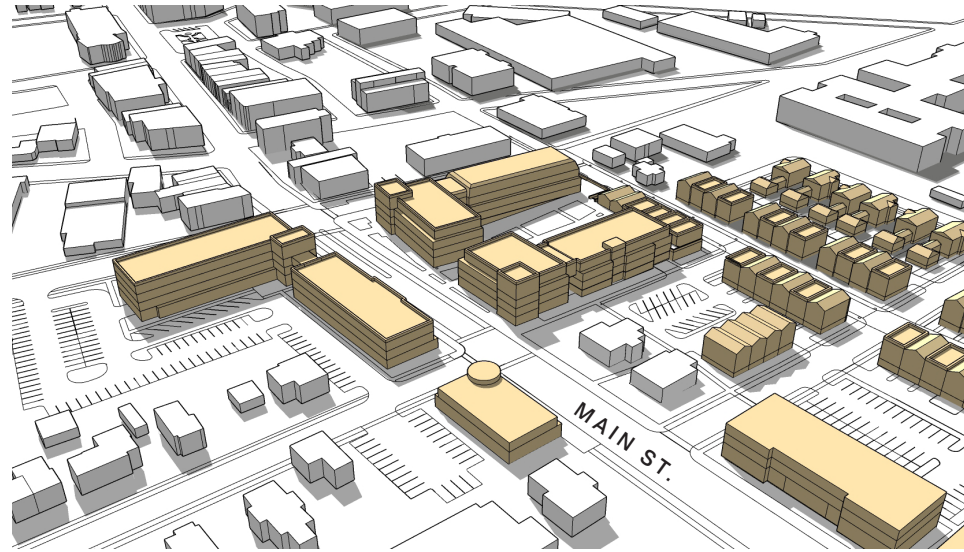

..... 9 am

..... 12 pm

..... 3 pm

Two - Stories

